

Ø 16 mm

TOPTEK®
HARDWARE ELECTRONIC MANUFACTURER



C-TOP-16F-J



Diameter: Ø 16mm
Switch Rating: 3A/250VAC
Contact Configuration: 1NO
Operation Type: Momentary
The Front Shape: Flat
The Crust Material:

- Stainless steel
- Copper plating

IP Degree: IP67, IK10

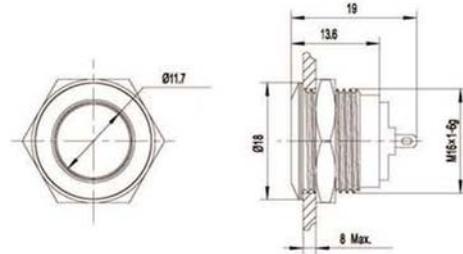

C-TOP-16B-J



Diameter: Ø 16mm
Switch Rating: 3A/250VAC
Contact Configuration: 1NO
Operation Type: Momentary
The Front Shape: Ball
The Crust Material:

- Stainless steel
- Copper plating

IP Degree: IP67, IK10

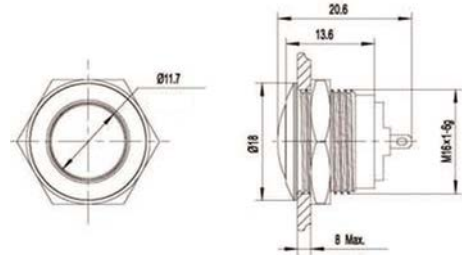

C-TOP-16H-J



Diameter: Ø 16mm
Switch Rating: 3A/250VAC
Contact Configuration: 1NO
Operation Type: Momentary
The Front Shape: High
The Crust Material:

- Stainless steel
- Copper plating

IP Degree: IP67, IK10

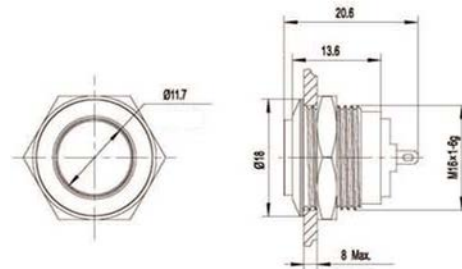

C-TOP-16F



Diameter: Ø 16mm
Switch Rating: 3A/250VAC
Contact Configuration: 1NO
Operation Type: Momentary
The Front Shape: Flat
The Crust Material:

- Stainless steel
- Copper plating

IP Degree: IP67, IK10

